

Heatshrinkable moulded shapes bulbous Angled T-Shapes, VG style - HellermannTyton

DRAWING No.  
**152043**

SHT. 1  
OF  
1 SHTS.

© THE COPYRIGHT OF THIS DRAWING IS RESERVED BY HELLERMANN TYTON. IT IS ISSUED ON CONDITION THAT IT IS NOT COPIED, REPRODUCED OR DISCLOSED TO A THIRD PARTY EITHER WHOLLY OR IN PART WITHOUT THE CONSENT IN WRITING OF HELLERMANN TYTON.

THIRD ANGLE PROJECTION

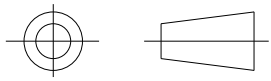

BS 8888

DO NOT SCALE  
IF IN DOUBT ASK

Q.A.	H/S SETT
H/S Q.A.	REL. INSP.
H/S PROD	EXT.ISS.CODE

STANDARD PART (AFTER UNRESTRICTED RECOVERY)

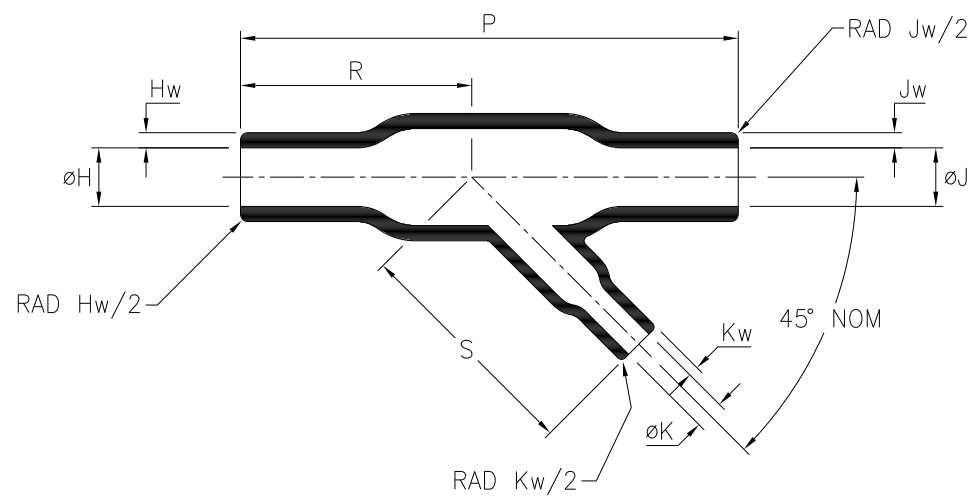

EXPANDED (AS SUPPLIED)

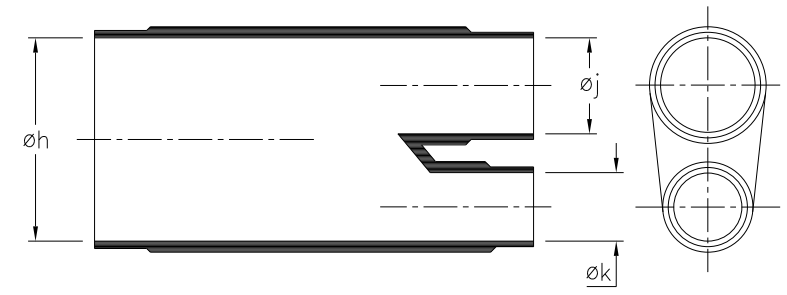

SPEC.	PART NO.	EXPANDED DIAMETERS (AS SUPPLIED)			RECOVERED DIAMETERS			RECOVERED DIMENSIONS					
		øh	øj	øk	øH	øJ	øK	P	R	S	Hw	Jw	Kw
		MIN	MIN	MIN	MAX	MAX	MAX	±10%	NOM	NOM	±30%	±30%	±30%
VG 95343 T08B004A	1302-1	27 (1.06)	27 (1.06)	7 (.28)	13 (.51)	13 (.51)	3.5 (.14)	92 (3.62)	41 (1.61)	36 (1.42)	2.5 (.10)	2.5 (.10)	1 (.04)
-	1302-2	39 (1.54)	39 (1.54)	10 (.39)	13 (.51)	13 (.51)	3.5 (.14)	92 (3.62)	41 (1.61)	36 (1.42)	2.5 (.10)	2.5 (.10)	1 (.04)

Heatshrinkable moulded shapes bulbous Angled T-Shapes, VG style - HellermannTyton

For information only, not subject to technical changes.

1	P1187	S.Almond	28/03/08
ISSUE	NOTE No.	DRAWN	DATE

**HellermannTyton**

Pennycross Close, Plymouth, Devon, England  
Tel ++44 (0) 1752 701201 Fax ++44 (0) 1752 790058

NAME	S.Almond	SCALE	NTS	ADHESIVE	A3 ORIGINAL SHEET SIZE 420mm x 297mm	SHT. 1 OF 1 SHTS.
DATE	28/03/08	DIMS IN	mm (in)			
TITLE	ANGLED TEE SLEEVE			PART No.	DRAWING No.	
				1302	152043	