

1:1

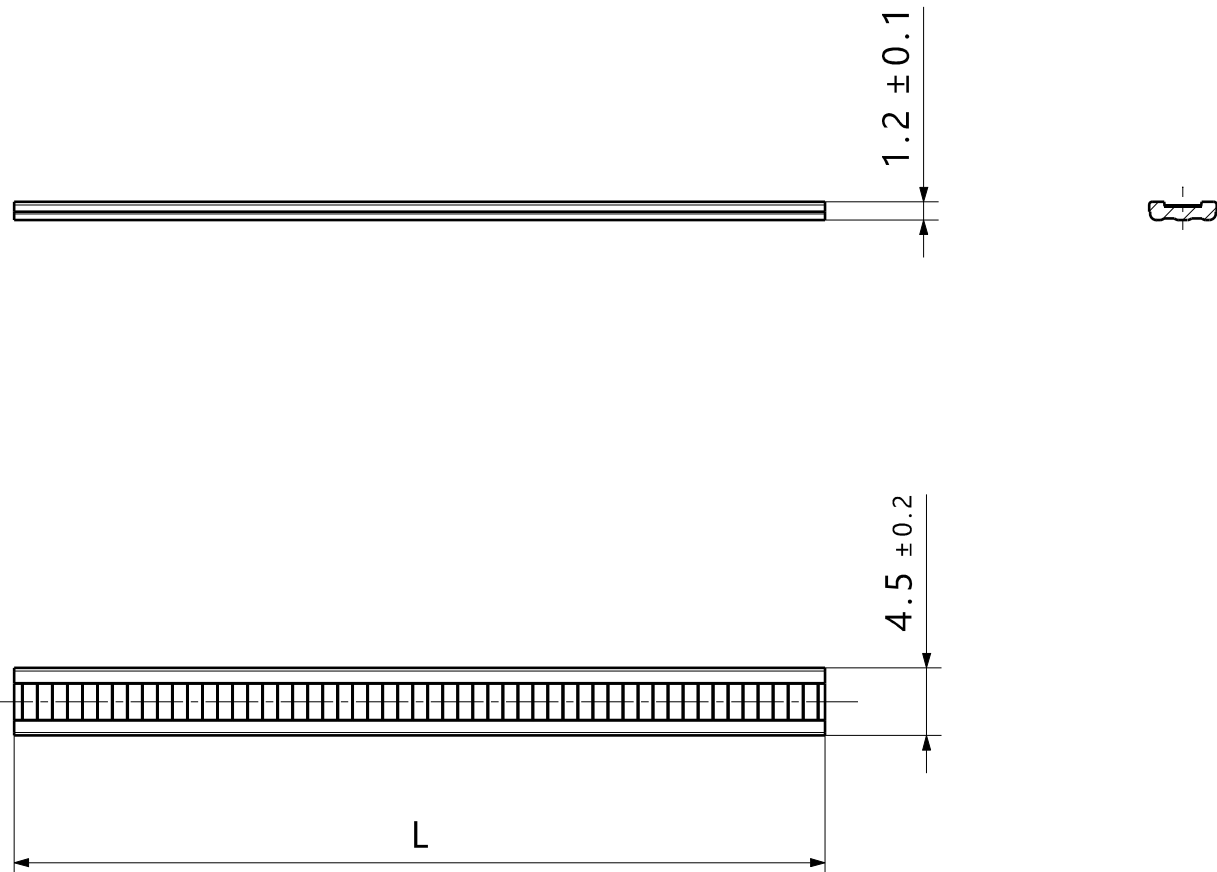

Printed copy for information only/  
Ausdruck nur zur Information

L= Length: 500m on reel

L=Laenge: 500m auf Spule

- Material: PA6.6  
impact modified,  
heat- and  
UV-stabilized

- Material: PA6.6 schlagzaeh  
modifiziert,  
hitze- und  
UV-stabilisiert

- Material color: black optional  
nature

- Material Farbe: schwarz wahlweise  
natur

The manufacturing-related geometry  
changes (injection point,  
ejectors marks, etc.) allowed.  
Design of the details are left to  
suppliers discretion.

Durch das Herstellverfahren bedingte  
Geometriaenderungen (Anspritzung,  
Auswerfermarkierungen, etc.) zulaessig.  
Einzelheiten der Ausfuehrung bleiben  
dem Hersteller ueberlassen.

Revision Level		
Drawing	State	Part
00.2	Design Release	01.1
Changed	Date (YYYY/MM/DD)	
Villbrandt	2020/10/21	
Approved	Date (YYYY/MM/DD)	
Schiwek	2020/10/21	

Revision Record	
Drawing and material revised	

All drawing  
revisions are  
stored in CAD  
PDM database

The copyright of  
this drawing is  
reserved by  
HellermannTyton.

Drawn	Date (YYYY/MM/DD)
Mueller	2001/10/16
Approved	Date (YYYY/MM/DD)
Wien	2001/10/16

Title		Strap ATS3080		Scale 5:1	
Drawing-No		14.1561		Global Project Number 12-0093	
				Format A3	
				Sheet 1 / 1	

**HellermannTyton**  
www.HellermannTyton.com